









DEPARTMENT		AREA
	1020000 - VICE PRESIDENT FOR ACADEMIC AFFAIRS	347
	1050000 - INFORMATION TECHNOLOGY	102
	2200000 - COLLEGE OF MEDICINE GENERAL	1,720
	2204000 - REGENERATIVE MEDICINE AND CELL BIO	4,228
	2220900 - RHEUMATOLOGY	1,195
	2248150 - CARDIOLOGY	2,050
	2258000 - NEUROSCIENCES	1,098
	2270300 - GENERAL SURGERY	1,112
TOTAL:		11,852
FLOOR GROSS:		17,527

ROOM	LOCATION CODE	OCCUPANT
CR601	730	
CR602JA	X01	
CR605	255	VISCONTI
CR605	255	COOK
CR605D2	255	YOST
CR605D2	255	HAEMMERICH
CR605D2	255	LEE
CR605D3	255	LEE
CR605D3	255	HAEMMERICH
CR605F	250B	HAEMMERICH
CR605F	250B	LEE
CR605F1	255	HAEMMERICH
CR605F1	255	LEE

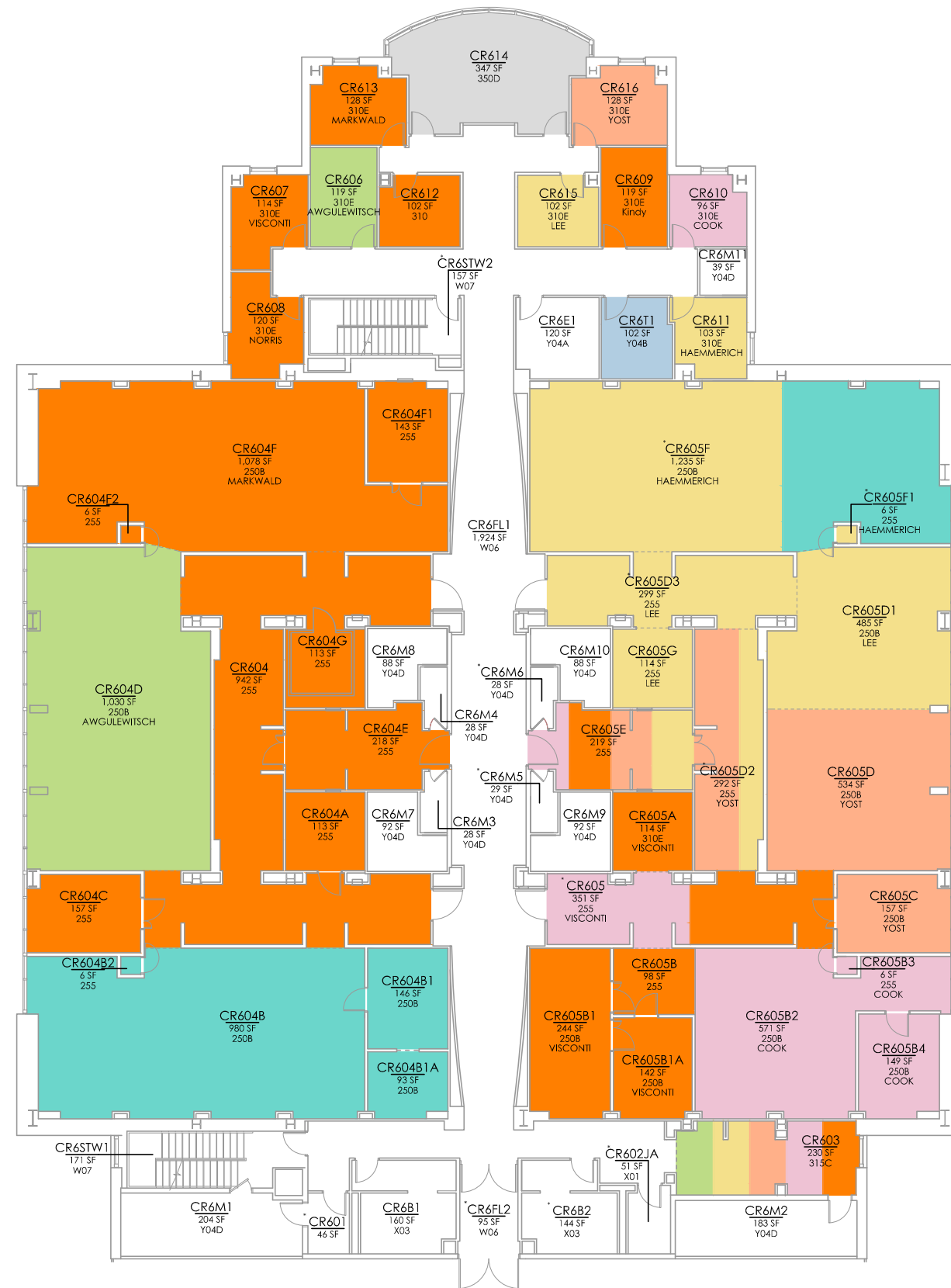

DEPARTMENT  
DARBY CHILDREN'S RESEARCH INSTITUTE